

Performance	
Weather - Tested to BS 6375 - 1:2009	
Air Permeability (ENG1026)	Class 4
Watertightness (ENG1027)	Class 9A 900pa
Resistance to windload (EN12211)	Class AE2100
Acoustic - Tested to BS EN 150 10140 - 2:2010	
Closed	31 dB Rw
100mm Opening	15 dB Rw
Fully Open	7 dB Rw
Environmental - Tested in accordance with BS EN ISO 10077-1	
U-Value	≤ 1.8 W/m ² °K based on recommended glazing spec
Green Guide Rating	E
Security	
Secure by Design compliance	LPS 1175 level 2 BS7950 Pass
Low / Medium Environmental Design Guide	
American Architectural Manufacturers Association (AAMA) 501.8-12 2719 Joules Impact Energy Test	
Tested by many NHS Trusts to replicate aggressive and continuous attack (video evidence available)	

Other	
Warranties	
12 month warranty (extendable by maintenance contract)	
Parts warranties up to 25 years and design life up to 35 years	
Quality	
Manufactured and installed in accordance with ISO 9001:2008 (certificate available)	
Sustainability	
All profiles used are environmentally sustainable and can be fully recycled supporting building energy performance	

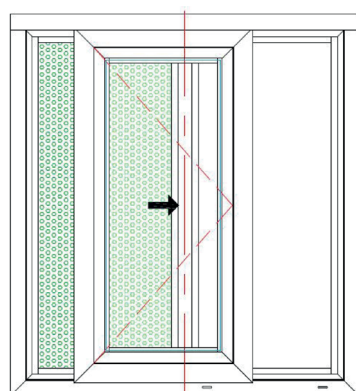

External view.
Further technical drawings are available on request.

Components	
Frame	
Profile	Bespoke aluminium profile extruded from aluminium alloy 6060/6063 T5/T6 and compliant with BS EN 12020-2: 2001/BS 755-9: 2001
Finish	All RAL / BS powder range / dual colour / bespoke finishes available to BS 6596. Anodising to BS EN 12373 and BS 3987
Thermal Break	Polyamide strips PA 6.6 25
UK Patent	2446730
Glazing Options	
Standard - Fixed Unit	- 10mm toughened (internal)
	- 20mm argon filled warm edge spacer
	- 6.8mm laminated soft coat (external)
Standard - Sash	- 6mm toughened soft coat (external)
	- 20mm argon filled warm edge spacer
	- 6mm toughened self clean (internal)
G-Value	Standard - 0.61*
Light Transmittance	Standard - 77%*
*Variations	Performance varies by glass specification. Combinations between 32-42mm available
Performance Applications	Self clean, Sand-blast, Solar, Mirrored, Obscure and Safety film
Visomesh	
Anti-tamper and anti-ligature 1.5mm thick stainless steel mesh. Double pressed for better vision and smoother finish. PPC or printed artwork finish.	
Perforation - Standard	2mm diameter holes to 3mm centres giving 40.3% open area
Perforation - Variations	3mm diameter holes on 4mm centres giving 51% open area
Blinds	
Integral Blinds	Electronically operated (20mm spacer required)
Hardware	
Operator	Anti-ligature window winder (steel or aluminium)
Locks (internal facing)	- Flush key lock (staff)
	- Manual thumb turn lock (patient)
Locks (external sash)	- Concealed key locks x2
Tricklevent Option	Anti-ligature permanently open
Fixings	
In strict accordance with the relevant British Standards, including BS 6262, fixings to be positioned 150mm from each corner, mullion, transom and at centres not exceeding 400mm or as advised dependent on structure.	